

8 7 6 5 4 3 2 1

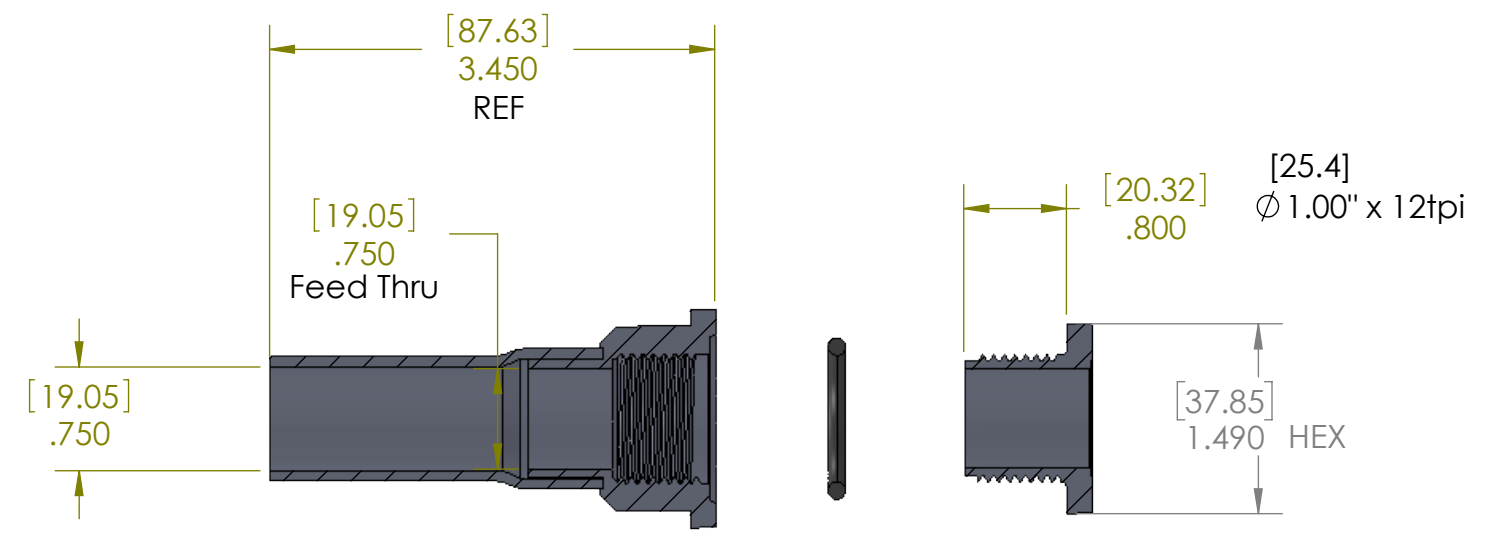
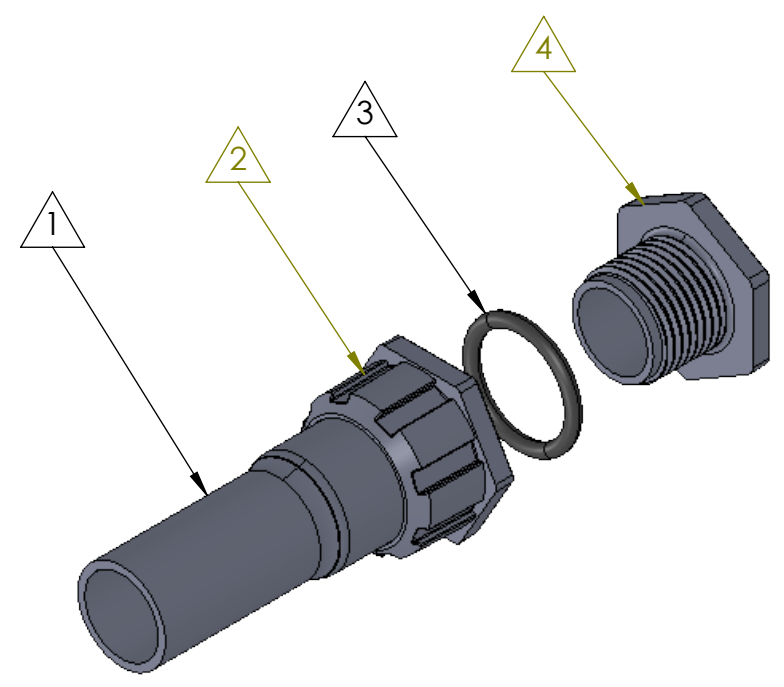
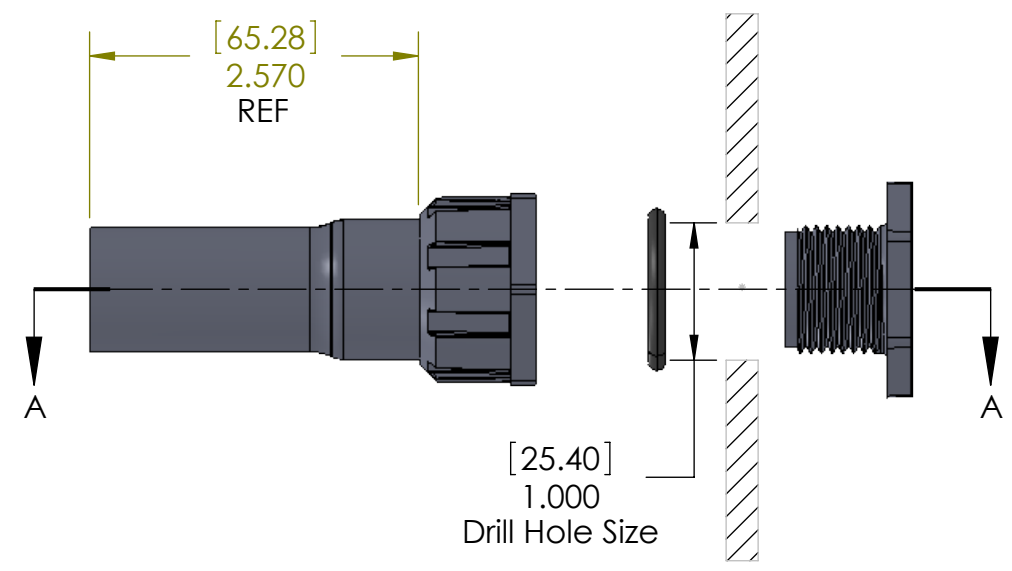

Expanded Min ID= Ø .750(19.05)
[Recovered Max ID= Ø .250(6.35)]

SECTION A-A

ITEM	PART DESCRIPTION	PART NO.	MATERIAL
1	Heat-shrinkable boot	M-1/4" x 3.0" Tube	HS 3123
2	Body	S-2B	Nylon
3	O-ring	S-2OR	Buna
4	Nut	S-2N	Nylon
5	Adhesive	A-010	Hotmelt ADH
6			

Nu-Tech

UNLESS OTHERWISE SPECIFIED: DIMENSIONS ARE IN INCHES TOLERANCES: FRACTIONAL ± 1/32 THREE PLACE DECIMAL ± 0.030 DO NOT SCALE DRAWING	PART NO.	
	NUS-2	
	DWG. NO.	S-020-AEA
	WEIGHT:	0.10
DRAWN: HH	DATE: 12/4/2019	SCALE: 2:3
		REV
		SHEET 1 OF 1

8 7 6 5 4 3 2 1