

8 7 6 5 4 3 2 1

REVISIONS		
REV.	DESCRIPTION	DATE
A	UPDATE DRAWING TO 2025 STANDARDS WITH TOLERANCE TABLE AND DECIMAL PRECISION ADJUSTED	12/31/2025

AS SUPPLIED
(EXPANDED STATE)

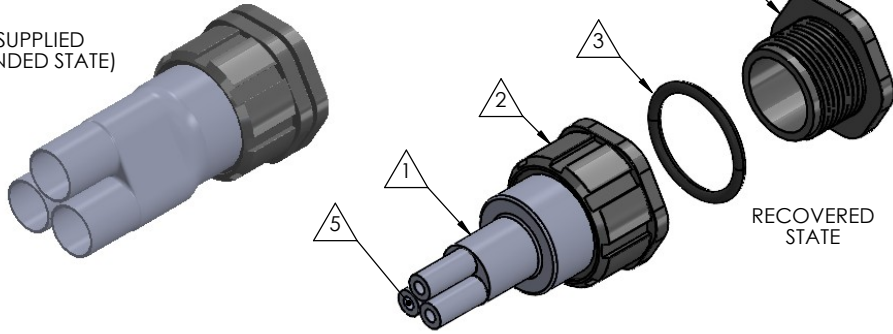

RECOVERED
STATE

NOTE: REFERENCE FOR SEAL ASSEMBLY INSTALLATION:
ASSEMBLY MAY BE INSTALLED IN PANELS FROM
0.11"(2.8mm) - 0.63"(16.0mm).
RECCOMENDED DRILL HOLE DIAMETER
OF 2.00" (50.8mm)

Expanded Min ID=0.90(22.9) REF
[Recovered Max ID=0.30(7.6)] REF

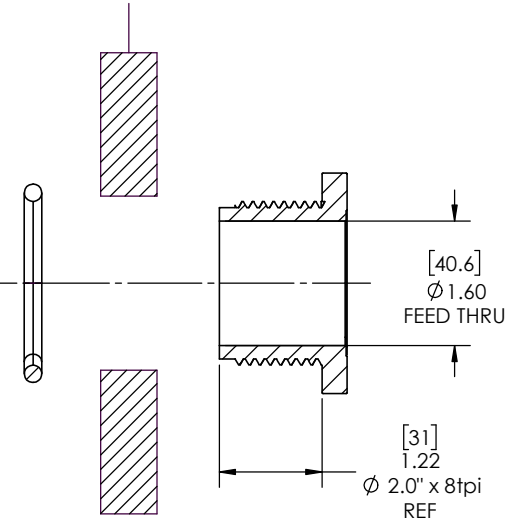
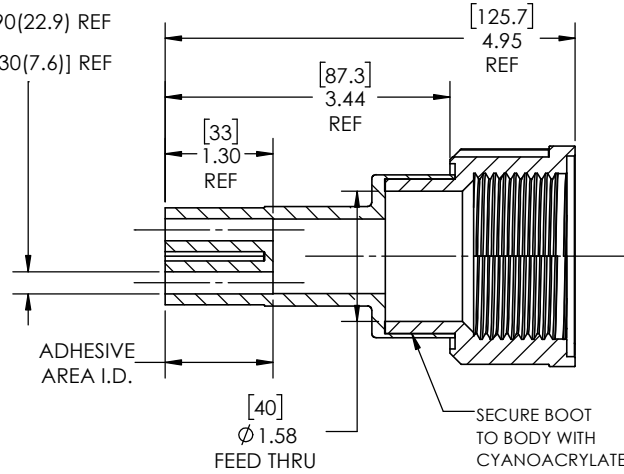
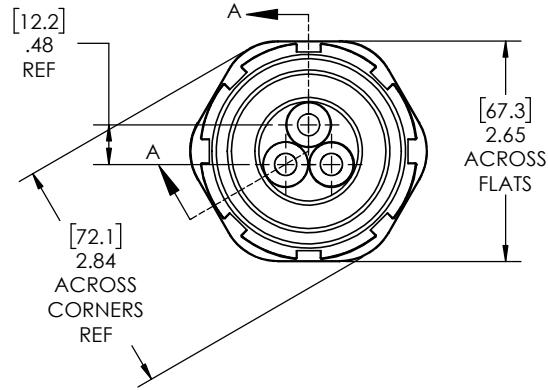

SECTION A-A
RECOVERED
SCALE 1 : 1.5

NOTES:

- ITEM#1 HEAT SHRINKABLE BOOT MATERIAL IS IN ACCORDANCE WITH POLYOLEFIN STANDARDS DEFINED IN SAE AS81765/1 REFERENCE DIMENSIONS MAY DEVIATE AS MUCH AS +OR- 1/4"
- FACTORY APPLIED HOT MELT ADHESIVE IS STANDARD

ITEM	PART DESCRIPTION	PART NO.	MATERIAL
1	Heat-shrinkable boot	NUBB3-3	Flame Retardant Polyolefin
2	Body	S-4B	Glass Fiber Reinforced, PBT
3	O-ring	AS-329	Buna
4	Nut	S-4N	Glass Fiber Reinforced, PBT
5	Adhesive		Hotmelt Polyamide

NU-TECH

UNLESS OTHERWISE SPECIFIED:
DIMENSIONS ARE IN INCHES
TOLERANCES:
FRACTIONAL ±1/32
ONE DECIMAL PLACE ± 0.060
TWO DECIMAL PLACE ± 0.025
THREE DECIMAL PLACE ± 0.010
DO NOT SCALE DRAWING

PART NO.
4-NUS-3C

DWG. NO. 4-NUS-3C-ASSY

WEIGHT: 0.397 REV A

DRAWN: MLJ DATE: 2/3/2026 SCALE: 1:1.5 SHEET 1 OF 1

8 7 6 5 4 3 2 1

8 7 6 5 4 3 2 1