

8 7 6 5 4 3 2 1

REVISIONS		
REV.	DESCRIPTION	DATE
A	UPDATE DRAWING TO 2025 STANDARDS	12/1/2025
B	REFINE DIMENSIONS AND DECIMAL PRECISION	12/16/2025
C	UPDATE TOLERANCE TABLE	12/30/2025

AS SUPPLIED
(EXPANDED STATE)

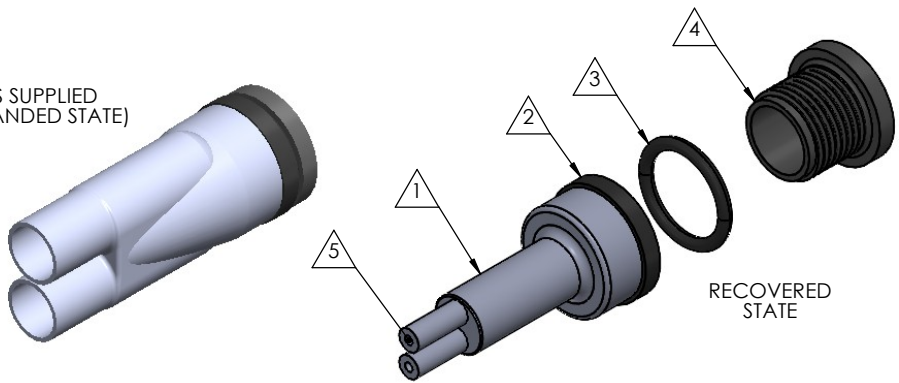

RECOVERED
STATE

NOTE: REFERENCE FOR SEAL ASSEMBLY INSTALLATION:
ASSEMBLY MAY BE INSTALLED IN PANELS FROM
0.08" (2.0mm) - 0.35" (8.9mm).
RECOMMENDED DRILL HOLE DIAMETER
OF 1.00" (25.4mm)

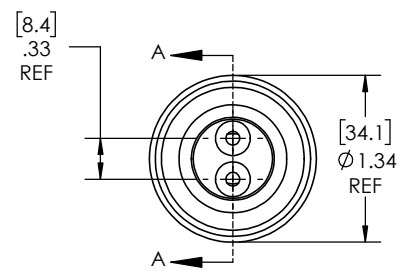

Expanded Min ID= 0.50(15.2) REF
[Recovered Max ID= 0.11(2.8)] REF

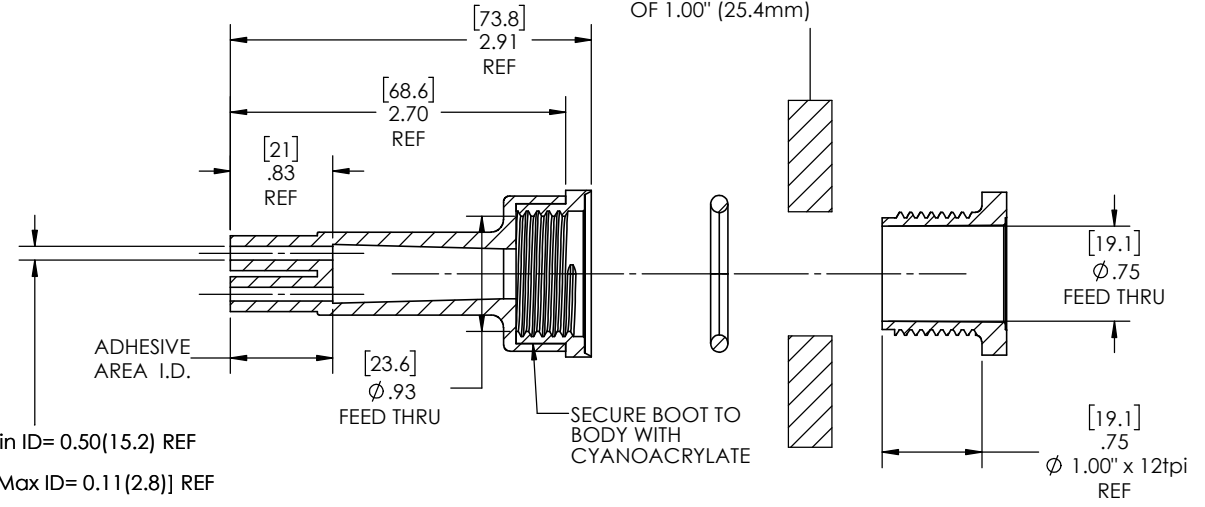

SECTION A-A
RECOVERED
SCALE 1 : 1

NOTES:

- ITEM# 1 HEAT SHRINKABLE BOOT MATERIAL IS IN ACCORDANCE WITH POLYOLEFIN STANDARDS DEFINED IN SAE AS81765/1 REFERENCE DIMENSIONS MAY DEVIATE AS MUCH AS +OR- 1/4"
- FACTORY APPLIED HOT MELT ADHESIVE IS STANDARD

ITEM	PART DESCRIPTION	PART NO.	MATERIAL
1	Heat-shrinkable boot	NUBB2-1	Flame Retardant Polyolefin
2	Body	S-2XB	Glass Fiber Reinforced, PBT
3	O-ring	AS-214	Buna
4	Nut	S-2XN	Glass Fiber Reinforced, PBT
5	Adhesive		Hotmelt Polyamide

NU-TECH

UNLESS OTHERWISE SPECIFIED: DIMENSIONS ARE IN INCHES TOLERANCES: FRACTIONAL ± 1/32 ONE DECIMAL PLACE ± 0.060 TWO DECIMAL PLACE ± 0.025 THREE DECIMAL PLACE ± 0.010 DO NOT SCALE DRAWING	PART NO.	
	2X-NUS-2A	
	DWG. NO.	REV
	2X-NUS-2A-ASSY	C
WEIGHT:	0.052	
DRAWN: MLJ	DATE: 3/11/2026	SCALE: 1:1
		SHEET 1 OF 1

8 7 6 5 4 3 2 1